



STAINLESS STEEL

150 LBS SCREWED FITTINGS

BSPP (ISO 228-1), BSPT (ISO 7-1), NPT THREAD

DIMENSION CONFORM TO ASME B16.3 AND ANSI/MSS SP-114-2018 WHERE APPLICABLE

MATERIAL CONFORM TO ASTM A351 GR. CF8 & CF8M

(PRESSURE-TEMPERATURE RATINGS 300 PSI-29 TO 66°C)

MADE BY LOST WAX INVESTMENT CASTING

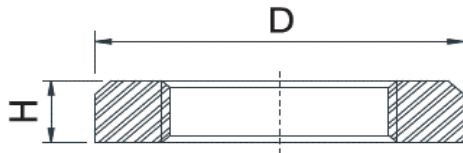

HEX NUT

SIZE	D	H	Weight
	(mm)	(mm)	(Kg/Pc)
1/8"	17.2	6.4	0.010
1/4"	18.9	7.0	0.010
3/8"	25.1	7.6	0.020
1/2"	31.8	8.4	0.030
3/4"	31.8	9.3	0.040
1"	31.8	9.5	0.060
1 1/4"	51.9	11.9	0.090
1 1/2"	58.2	12.0	0.110
2"	71.6	13.3	0.170
2 1/2"	89.4	15.0	0.290
3"	102.3	17.3	0.440
4"	127.3	18.0	0.540